

TECHNICAL DATA SHEET # 40B

H-50 HANGER ROD INSTALLATION INSTRUCTIONS

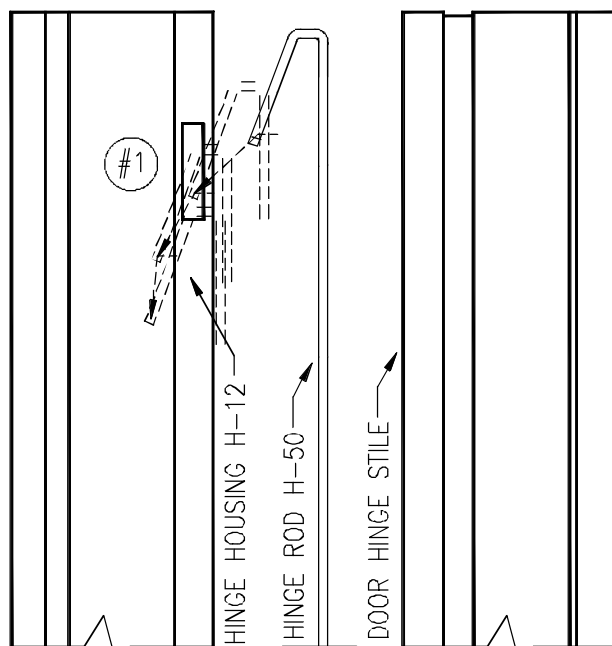

#1 ENGAGE THE HANGER POD IN THE SLOT IN THE HINGE HOUSING, H12 AS SHOWN.

#2 WITH THE DOOR IN THE POSITION AS SHOWN, TILT THE TOP OF THE DOOR AWAY FROM THE HINGE JAMB TO RAISE THE HINGE STILE.

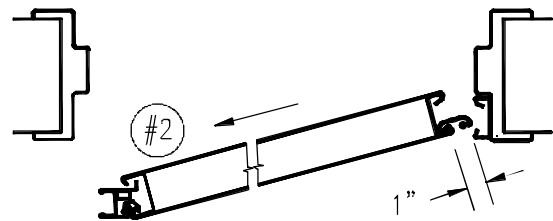

#3 ENGAGE THE HANGER POD IN THE DOOR BODY AND GENTLY LOWER DOOR BODY ONTO HANGER ROD. *DO NOT DROP DOOR ON HANGER ROD. DOING SO, CAN CAUSE HANGER ROD FAILURE.

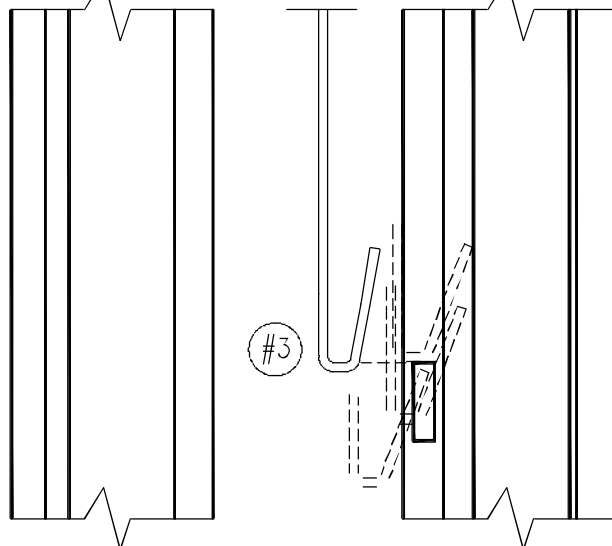

*WHEN PERFORMING THE ABOVE STEPS, DO NOT PULL DOOR AWAY FROM THE JAMB BY MORE THAN 6". DOING SO, CAN CAUSE HANGER ROD FAILURE.

*DO NOT OPEN UP THE HOOK. THIS WILL CAUSE THE HANGER ROD TO FAIL

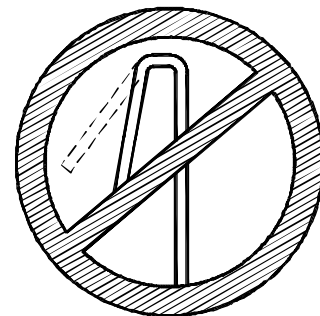

Total Door SYSTEMS™
Global Leader in Integrated Access Technology™

TEL. (800) 852-6660

www.totaldoor.com

© Total Door 2019

FILE NAME

TDS40B

DATE 1/14/19